

Ni-MH rechargeable cylindrical cell (Data Sheet)

Specification

Nominal Voltage		1.2V	
Dimensions	Diameter	32.2±0.2mm	
	Height	61.2±0.3mm	
	Apx. Weight	165g	
0.2C Discharge Capacity	Typical	7050mAh	
	Minimum	7000mAh	
Typical Internal Impedance		Less than 10mΩ	
Charge	Standard	700mA for 16hrs	
	Fast	3500mA for about 150min	
Life expectancy		500 cycles	
Operating Temperature	Charge	Standard	0°c to 40°c
		Fast	10°c to 40°c
	Discharge		-10°c to 50°c
	Storage	< 1 year	-10°c to 30°c
< 3 months		-10°c to 40°c	

CHARGE CHARACTERISTICS

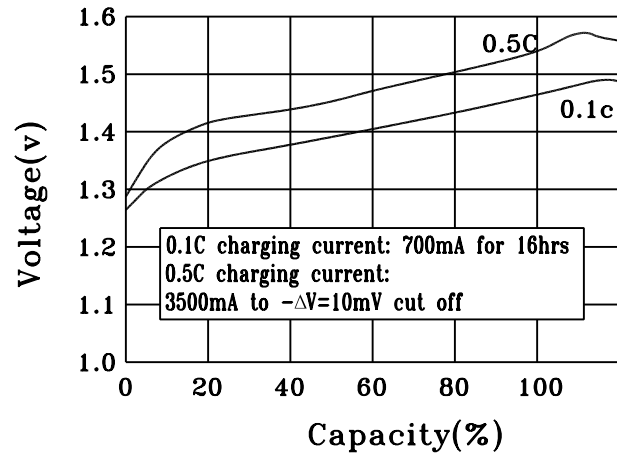

DISCHARGE CHARACTERISTICS

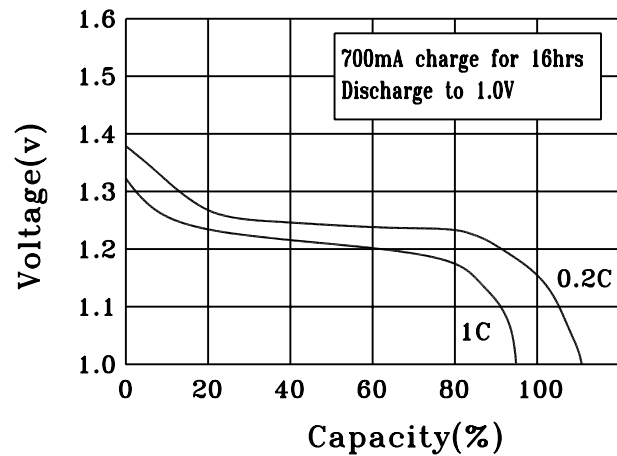

DISCHARGE CHARACTERISTICS AT DIFFERENT TEMPERATURE

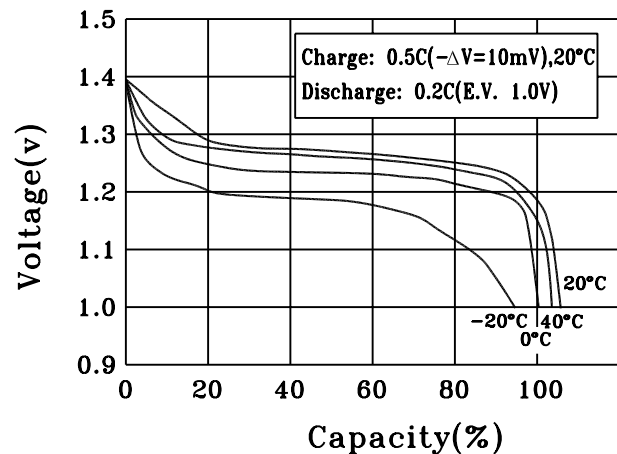

(CELL DIMENSIONS)

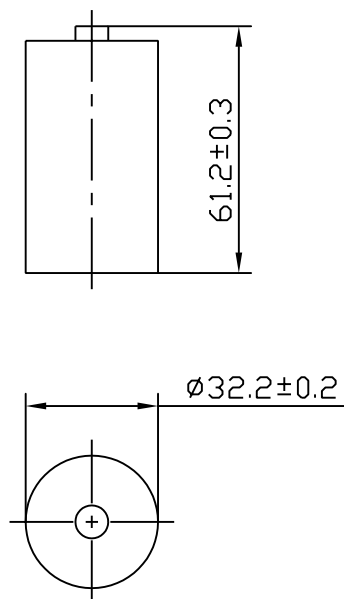

(With tube)

1:2