

Ni-MH rechargeable cylindrical cell (Data Sheet)

Specification

Nominal Voltage		1.2V	
Dimensions	Diameter	25.2±0.2mm	
	Height	49.5±0.3mm	
	Apx. Weight	42g	
0.2C Discharge Capacity	Typical	1850mAh	
	Minimum	1800mAh	
Typical Internal Impedance		Less than 15mΩ	
Charge	Standard	180mA for 16 hrs	
	Fast	900mA for about 150mins	
Life expectancy		500 cycles	
Operating Temperature	Charge	Standard	0°c to 40°c
		Fast	10°c to 40°c
	Discharge		-10°c to 50°c
	Storage	< 1 year	-10°c to 30°c
< 3 months		-10°c to 40°c	

(CELL DIMENSIONS)

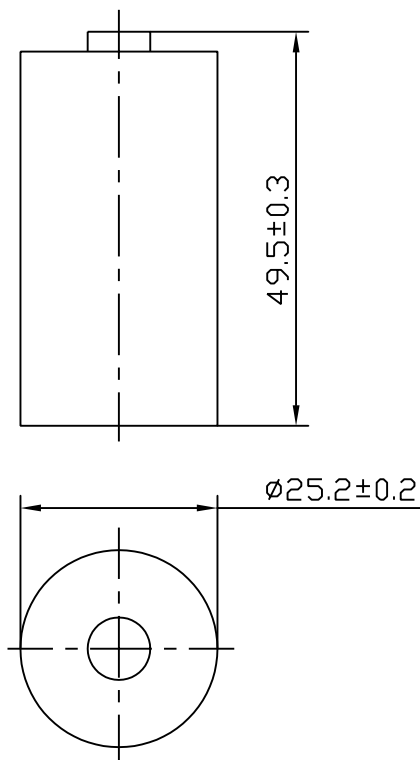

(With tube)

1:1

CHARGE CHARACTERISTICS

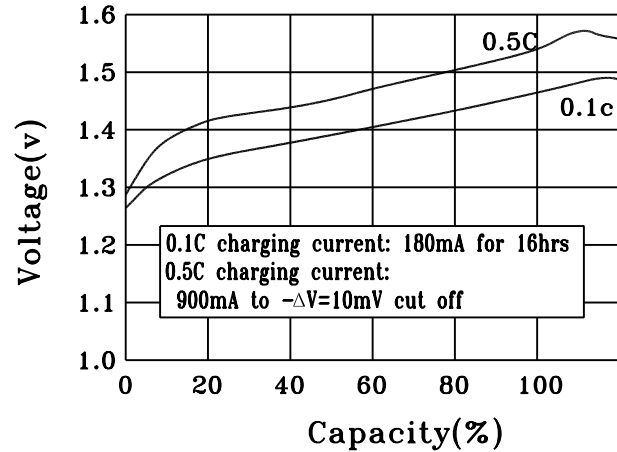

DISCHARGE CHARACTERISTICS

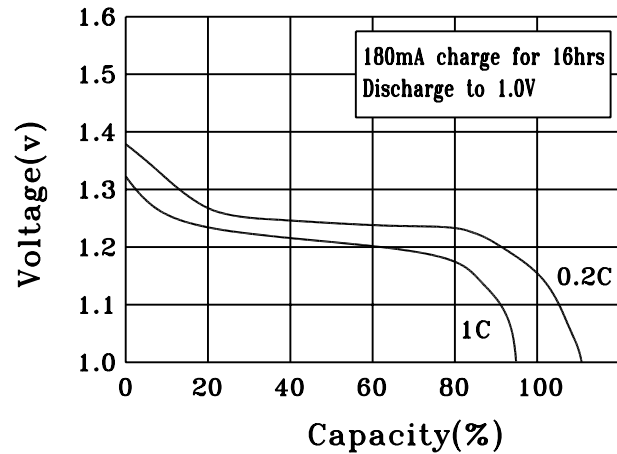

DISCHARGE CHARACTERISTICS AT DIFFERENT TEMPERATURE

