

Ni-Cd rechargeable cylindrical cell (Data Sheet)

Specification

Nominal Voltage		1.2V	
Dimensions	Diameter	13.9±0.2mm	
	Height	17.0±0.3mm	
	Apx. Weight	8g	
0.2C Discharge Capacity	Typical	200mAh	
	Minimum	180mAh	
Typical Internal Impedance		Less than 70mΩ	
Charge	Standard	18mA for 16 hrs	
	Fast	180mA for about 75min	
Life expectancy		500 cycles	
Operating Temperature	Charge	Standard	0°C to 40°C
		Fast	10°C to 40°C
	Discharge		-10°C to 50°C
	Storage	< 1 year	-10°C to 30°C
< 3 months		-10°C to 40°C	

CHARGE CHARACTERISTICS

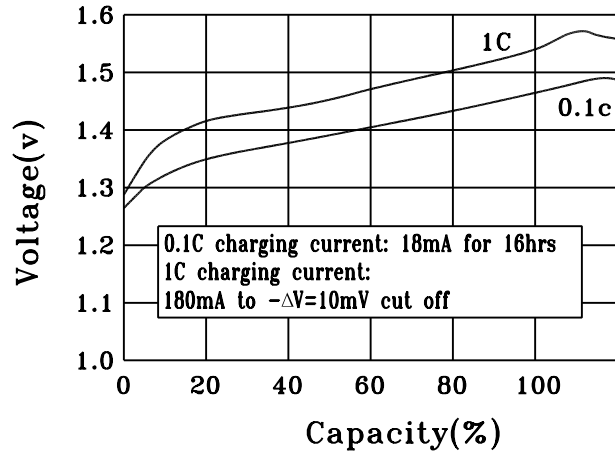

DISCHARGE CHARACTERISTICS

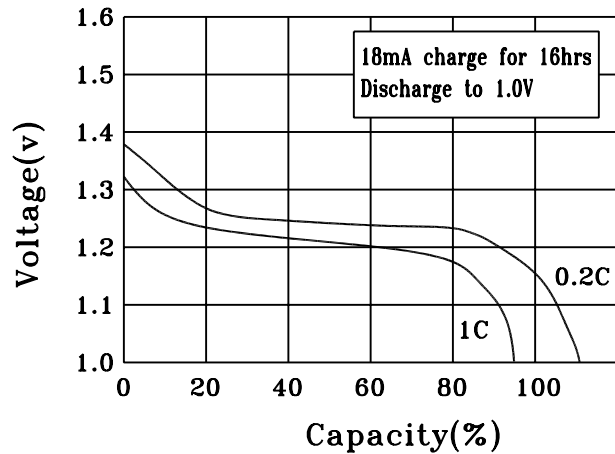

DISCHARGE CHARACTERISTICS AT DIFFERENT TEMPERATURE

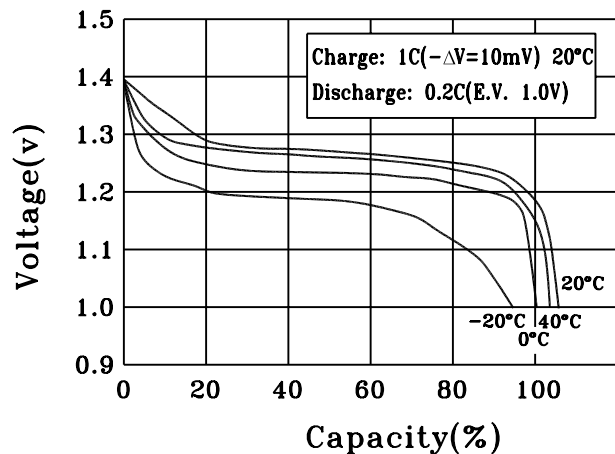

(CELL DIMENSIONS)

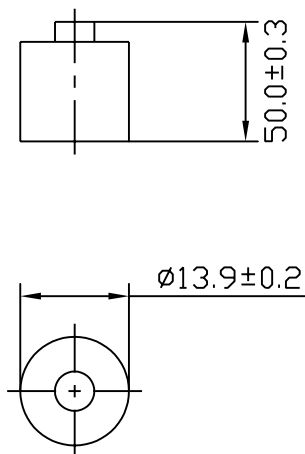

(With tube)

1:1