

Ni-MH rechargeable cylindrical cell (Data Sheet)

Specification

Nominal Voltage		1.2V	
Dimensions	Diameter	16.5±0.2mm	
	Height	28.0±0.3mm	
	Apx. Weight	21g	
0.2C Discharge Capacity	Typical	1150mAh	
	Minimum	1100mAh	
Typical Internal Impedance		Less than 30mΩ	
Charge	Standard	110mA for 16 hrs	
	Fast	1100mA for about 75min	
Life expectancy		500 cycles	
Operating Temperature	Charge	Standard	0°C to 40°C
		Fast	10°C to 40°C
	Discharge		-10°C to 50°C
	Storage	< 1 year	-10°C to 30°C
< 3 months		-10°C to 40°C	

CHARGE CHARACTERISTICS

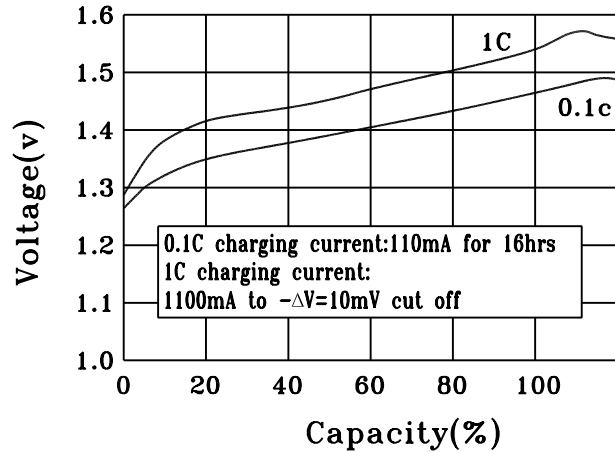

DISCHARGE CHARACTERISTICS

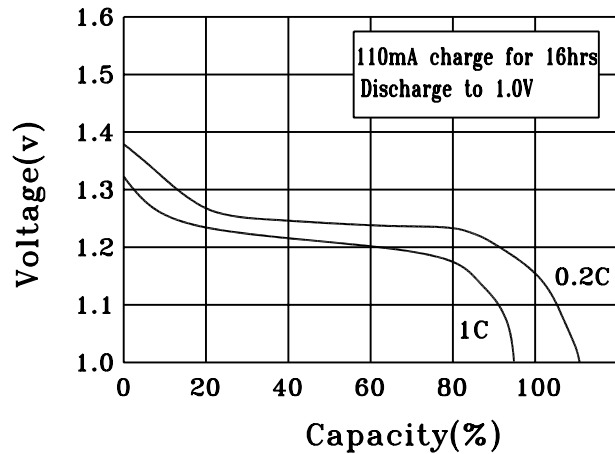

DISCHARGE CHARACTERISTICS AT DIFFERENT TEMPERATURE

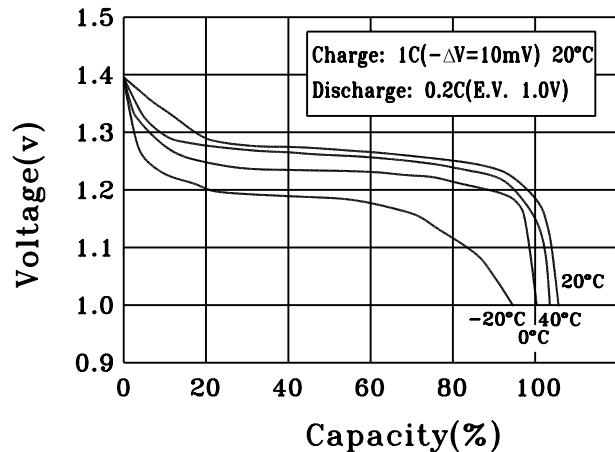

(CELL DIMENSIONS)

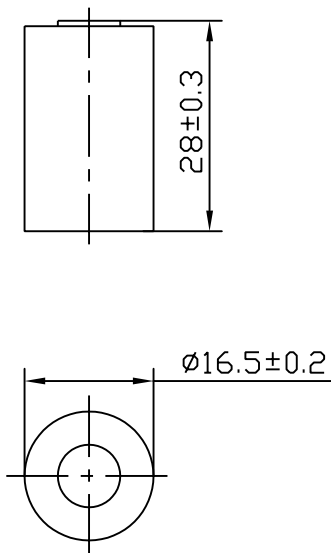

(With tube)

1:1