

Ni-Cd rechargeable cylindrical cell (Data Sheet)

Specification

Nominal Voltage		1.2V	
Dimensions	Diameter	25.2±0.2mm	
	Height	49.5±0.3mm	
	Apx. Weight	73g	
0.2C Discharge Capacity	Typical	2850mAh	
	Minimum	2800mAh	
Typical Internal Impedance		Less than 20mΩ	
Charge	Standard	280mA for 16hrs	
	Fast	1400mA for about 150min	
Life expectancy		500 cycles	
Operating Temperature	Charge	Standard	0°c to 40°c
		Fast	10°c to 40°c
	Discharge		-10°c to 50°c
	Storage	< 1 year	-10°c to 30°c
< 3 months		-10°c to 40°c	

CHARGE CHARACTERISTICS

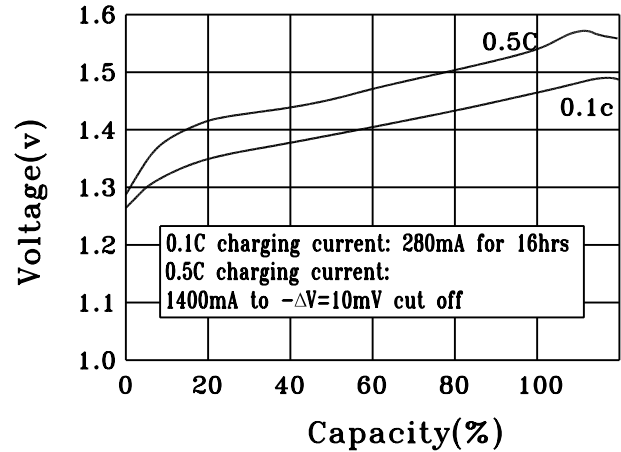

DISCHARGE CHARACTERISTICS

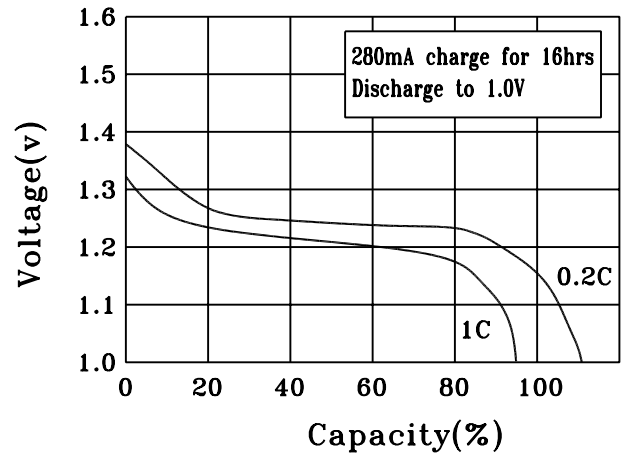

DISCHARGE CHARACTERISTICS AT DIFFERENT TEMPERATURE

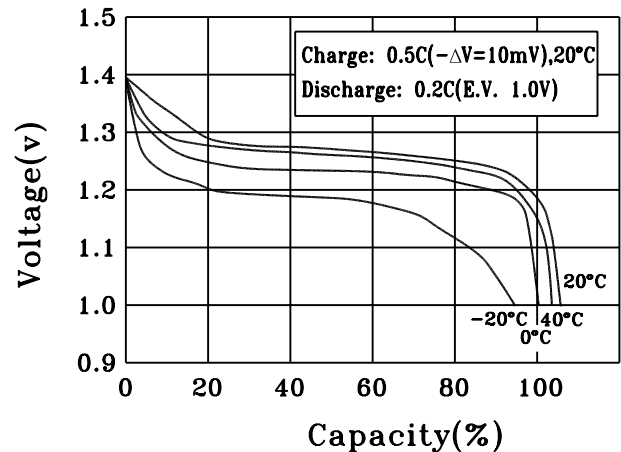

(CELL DIMENSIONS)

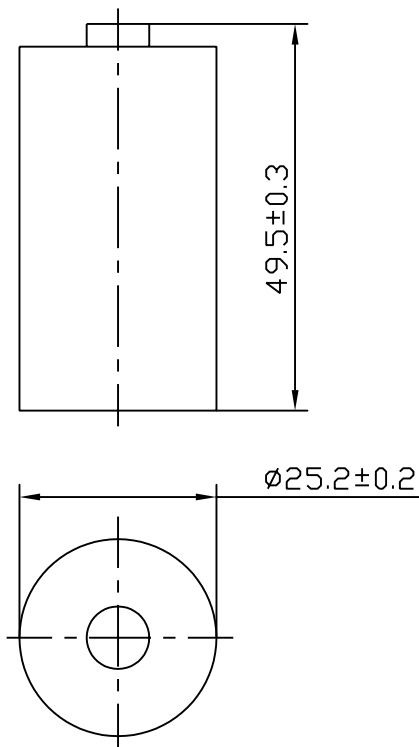

(With tube)

1:1