

Ni-Cd rechargeable cylindrical cell (Data Sheet)

Specification

| | | | |
|----------------------------|-------------|------------------------|---------------|
| Nominal Voltage | | 1.2V | |
| Dimensions | Diameter | 25.2±0.2mm | |
| | Height | 49.5±0.3mm | |
| | Apx. Weight | 56g | |
| 0.2C Discharge Capacity | Typical | 1550mAh | |
| | Minimum | 1500mAh | |
| Typical Internal Impedance | | Less than 20mΩ | |
| Charge | Standard | 150mA for 16hrs | |
| | Fast | 1500mA for about 75min | |
| Life expectancy | | 500 cycles | |
| Operating Temperature | Charge | Standard | 0°C to 40°C |
| | | Fast | 10°C to 40°C |
| | Discharge | | -10°C to 50°C |
| | Storage | < 1 year | -10°C to 30°C |
| < 3 months | | -10°C to 40°C | |

CHARGE CHARACTERISTICS

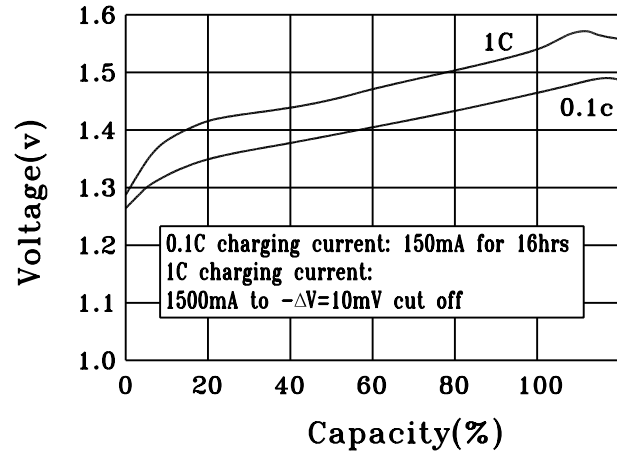

DISCHARGE CHARACTERISTICS

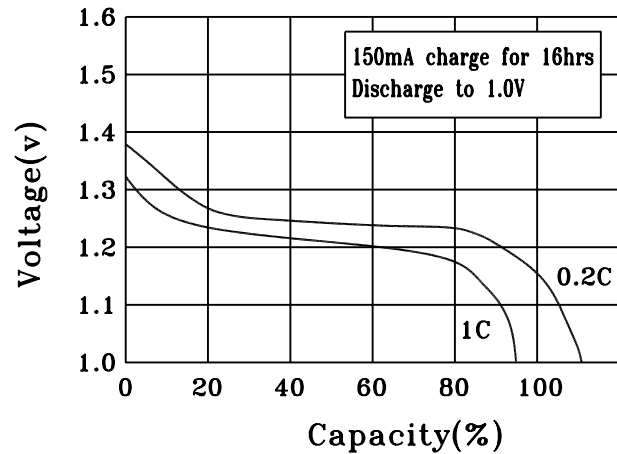

DISCHARGE CHARACTERISTICS AT DIFFERENT TEMPERATURE

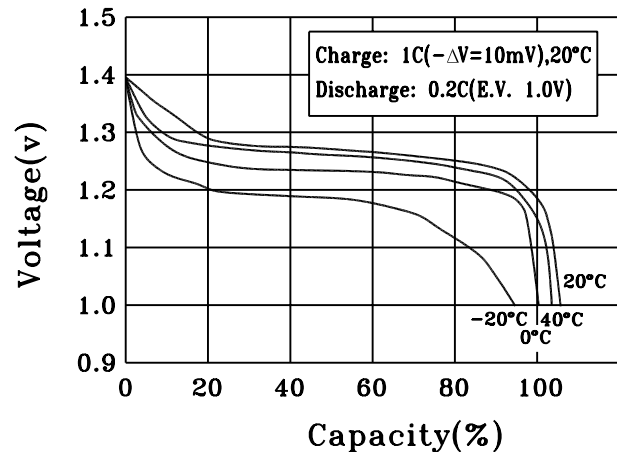

(CELL DIMENSIONS)

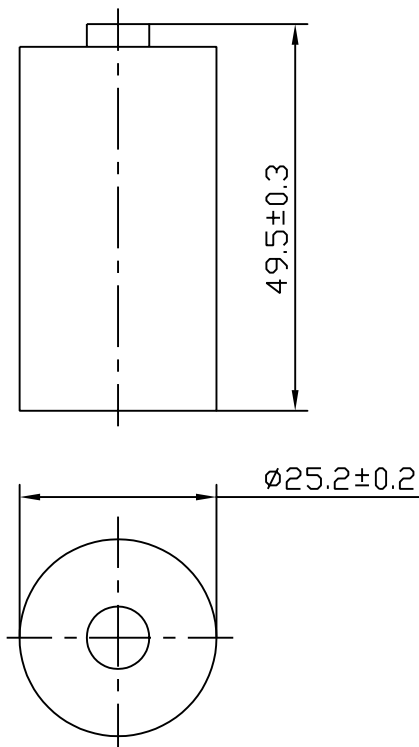

(With tube)

1:1