

Ni-Cd rechargeable cylindrical cell (Data Sheet)

Specification

|                            |             |                         |               |
|----------------------------|-------------|-------------------------|---------------|
| Nominal Voltage            |             | 1.2V                    |               |
| Dimensions                 | Diameter    | 32.2±0.2mm              |               |
|                            | Height      | 61.2±0.3mm              |               |
|                            | Apx. Weight | 145g                    |               |
| 0.2C Discharge Capacity    | Typical     | 5050mAh                 |               |
|                            | Minimum     | 5000mAh                 |               |
| Typical Internal Impedance |             | Less than 15mΩ          |               |
| Charge                     | Standard    | 500mA for 16hrs         |               |
|                            | Fast        | 2500mA for about 150min |               |
| Life expectancy            |             | 500 cycles              |               |
| Operating Temperature      | Charge      | Standard                | 0°c to 40°c   |
|                            |             | Fast                    | 10°c to 40°c  |
|                            | Discharge   |                         | -10°c to 50°c |
|                            | Storage     | < 1 year                | -10°c to 30°c |
| < 3 months                 |             | -10°c to 40°c           |               |

CHARGE CHARACTERISTICS

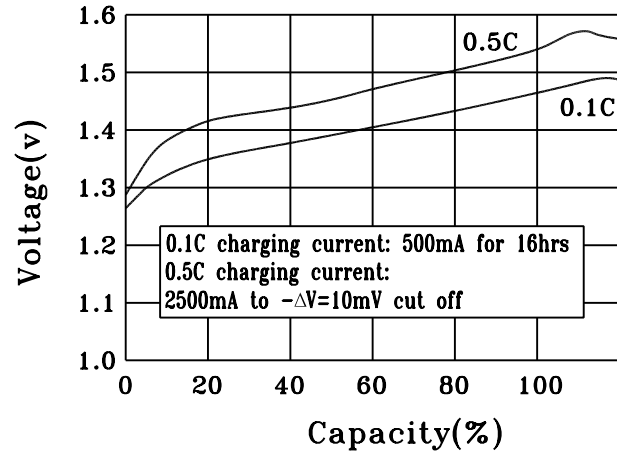

DISCHARGE CHARACTERISTICS

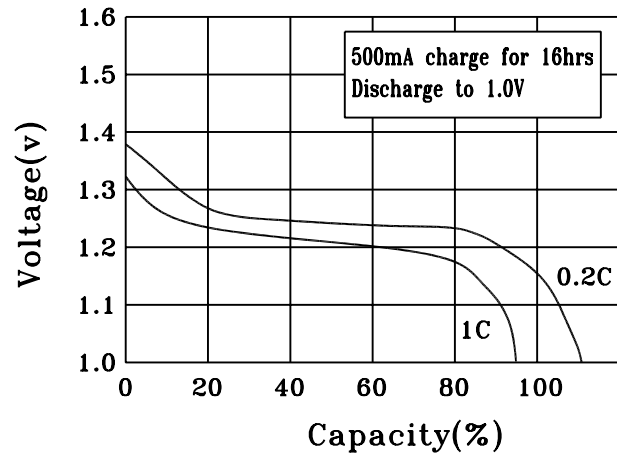

DISCHARGE CHARACTERISTICS AT DIFFERENT TEMPERATURE

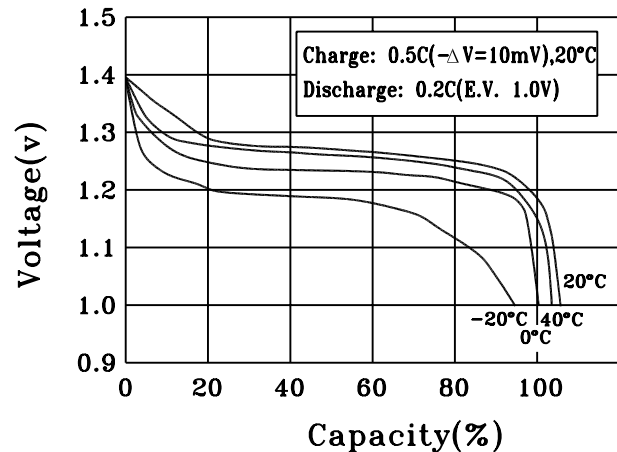

(CELL DIMENSIONS)

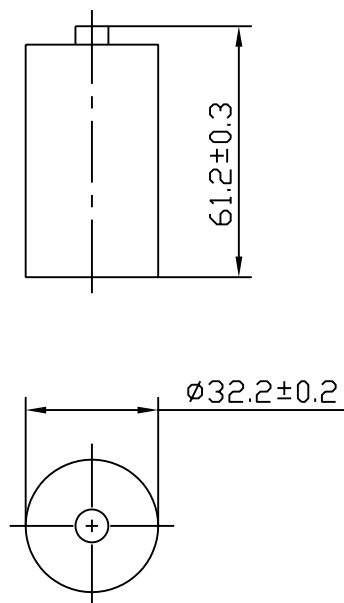

(With tube)

1:2